

# TUFTS UNIVERSITY PARKING GARAGE MEDFORD, MASSACHUSETTS

- OWNER  
Tufts University
- ARCHITECT  
ADD, Inc.
- CONSTRUCTION COST  
\$12,000,000
- GENERAL CONTRACTOR  
Kay Construction Company



Six Levels of Parking, One Level of Office Space



Pedestrian Bridge to Dowling Hall

## PROJECT DESCRIPTION

Structural design of a 7-story building on the Medford portion of the main campus involving new construction of six levels of parking (510 spaces) and one level of office space (32,000 s.f.)

Reinforced concrete Filigree beams and slabs were used in the 6-story parking garage. Structural steel was used in the seventh floor office portion and the roof. Reinforced concrete shear walls and steel braced frames provided lateral load resisting capacity in the long direction. Lateral resistance in the short direction was provided by ordinary steel moment frames which also carried the unbalanced lateral soil pressure from the heavily sloping site.

A 150-foot long pedestrian bridge provided direct access from the campus to the seventh floor offices (Dowling Hall). The top chord of the bridge trusses was designed as an elastically restrained member. A central pier supported the bridge. The bridge was separated from the seventh floor plaza by an expansion joint. The plaza and bridge were equipped with a snow melting system embedded in the concrete slab to avoid snow and ice accumulation.

*Received the National Design-Build Excellence Award  
from Design-Build Institute of America*

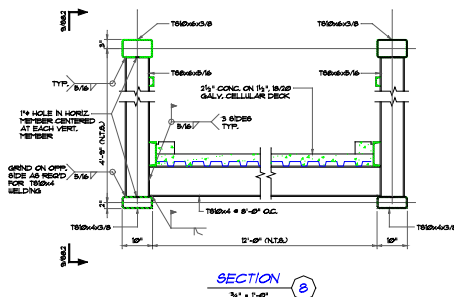

**DMBC**  
STRUCTURAL ENGINEERS  
DM BERG CONSULTANTS, P.C.  
SERVING THE INDUSTRY SINCE 1963

CONSULTING ENGINEERS  
570 Hillside Avenue  
Needham, MA  
02494-1297  
p 781 444-5156  
f 781 444-5157  
www.dmberg.com